

# CENTER TOWNSHIP SECTION 8 R10- TWP 6 MORGAN COUNTY, OH

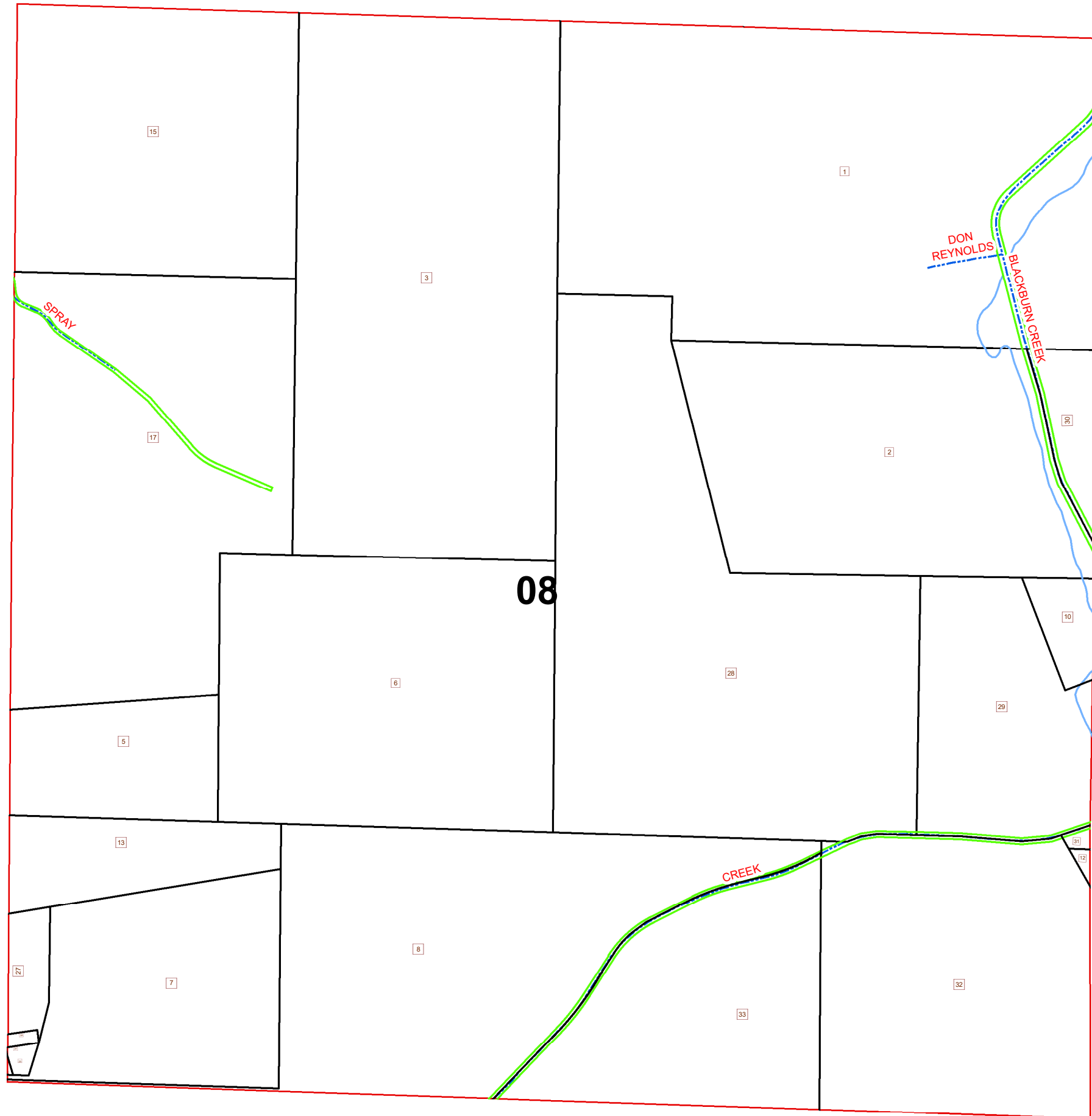

PIN	VOL	PAGE	Owner	LegalDescr	Acres
030-003-150-0	OR200	557	BICKFORD DENNIS L	R10 T06 S08 SD 2	46.034
030-001-650-0	OR230	1	CNX LAND LLC	R10 T06 S08 SD 10 B	3.5
030-001-900-0	OR221	2385	CORBETT R CAUDILL CHIPPING	R10 T06 S08 SD 33	23.72
030-002-400-0	OR225	2084	DEPUY RANDY ET5AL C/O DEP	R10 T06 S08 SD 7 EX 25.253	
030-005-840-0	OR231	3707	DROBINA SAMANTHA C	R10 T06 S08 SD 17 D	61.31
030-007-870-0	OR208	1372	FERGUSON TYLER D	R10 T06 S08 SD 15	41.825
030-003-150-1	OR232	5800	FOSS MADONNA L & JAMMIE	R10 T06 S08 SD 30 S	4.431
030-001-870-0	OR229	1546	HERSHBERGER WAYNE A ET 9	R10 T06 S08 SD 8 N	52.51
030-002-110-0	OR234	551	MILLER THOMAS D & SARAH	R10 T06 S08 SD 12 S	0.237
030-003-161-1	OR234	551	MILLER THOMAS D & SARAH	R10 T06 S08 SD 31 S	0.287
030-000-210-0	OR123	430	PORTER JEFFREY L & WESLY	R10 T06 S08 SD 23 S	0.461
030-000-160-0	OR126	134	PORTER JEFFREY L & WESLY	R10 T06 S08 SD 22 S	0.033
030-000-190-0	OR123	430	PORTER JEFFREY L & WESLY	R10 T06 S08 SD 24 S	0.226
030-004-520-0	OR213	3245	STEGNER EDWARD D	R10 T06 S08 SD 27	2.59
030-007-910-0	OR208	78	STEGNER HARRY M	R10 T06 S08 SD 6	50
030-007-800-0	OR178	787	STEGNER LOUELLA TOD: HAR	R10 T06 S08 SD 13	11
030-007-780-0	OR178	787	STEGNER LOUELLA TOD: HAR	R10 T06 S08 SD 5	18
030-007-290-0	OR202	1356	STEPHENS RYAN R	R10 T06 S08 SD 1	90.5
030-007-860-0	OR208	657	STEPHENS RYAN R	R10 T06 S08 SD 3	80
030-003-160-2	OR200	548	WELCH JERRY & VICTORIA P	R10 T06 S08 SD 29 S	22.188
030-003-160-1	OR200	545	WELCH JERRY M & VICTORIA	R10 T06 S08 SD 28 S	75.325
030-002-110-1	OR223	1622	ZIELENIEWSKI JOHN	R10 T06 S08 SD 32	41.248

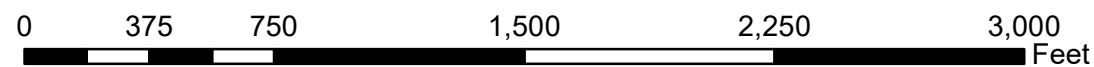
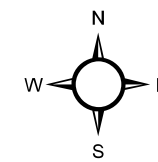

Disclaimer: The information that these maps contains is or reference purposes only. Please bring any erros to the attention of the Engineer's Office staff.  
Thank you

Source: Morgan County Engineer's Office  
Author: Marcia Wolfe  
Date: 3/2/2020